

SHOP 1
42 sq m / 452 sq ft
#01-01

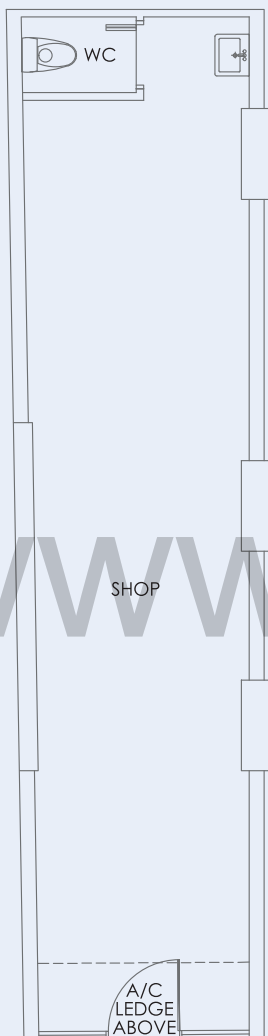

SHOP 2
40 sq m / 431 sq ft
#01-02



SHOP 3
40 sq m / 431 sq ft
#01-03



SHOP 4
33 sq m / 355 sq ft
#01-04



www.huttonsgroup.com

Note: Unit area includes AC ledge and/or AC accessory lot and/or void and/or roof terrace where applicable. All plans are subject to amendments as approved by the relevant authorities.

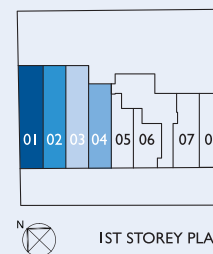

1ST STOREY PLAN

SHOP 5
25 sq m / 269 sq ft
#01-05

SHOP 6
23 sq m / 248 sq ft
#01-06

SHOP 7
31 sq m / 334 sq ft
#01-07

SHOP 8
34 sq m / 366 sq ft
#01-08

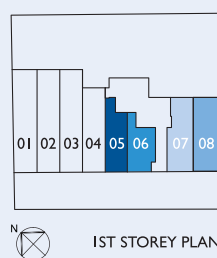
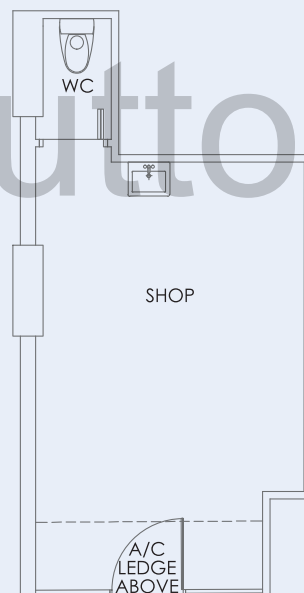

Note: Unit area includes AC ledge and/or AC accessory lot and/or void and/or roof terrace where applicable. All plans are subject to amendments as approved by the relevant authorities.

TYPE AI-I
1 bedroom
54 sq m / 581 sq ft
#02-01

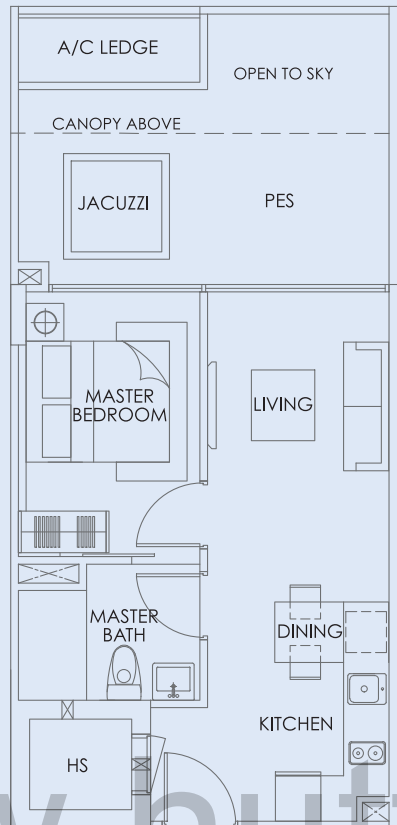

TYPE AIa
1 bedroom
40 sq m / 431 sq ft
#03-01

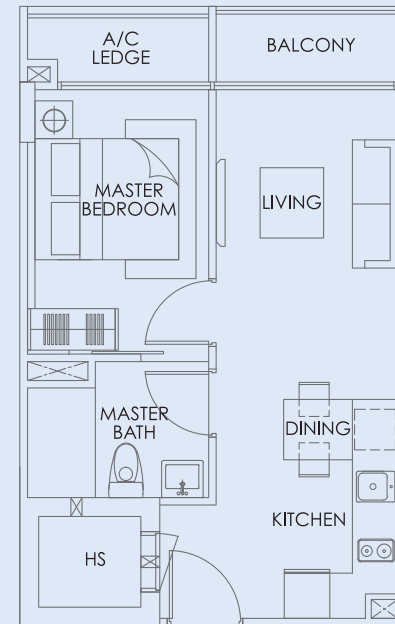

TYPE AI
1 bedroom
40 sq m / 431 sq ft
#04-01 to #05-01

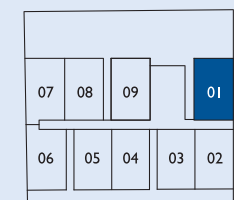
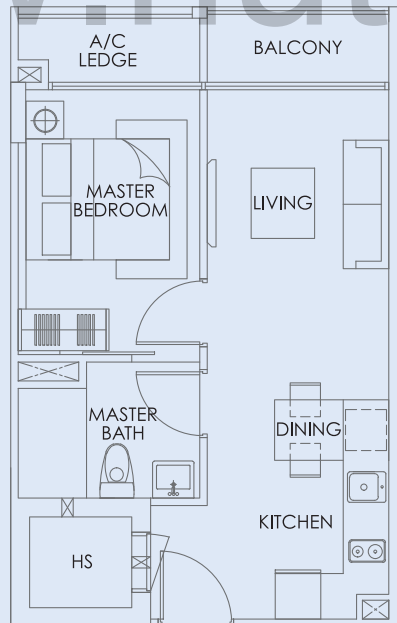

3RD STOREY PLAN
TO 6TH STOREY PLAN

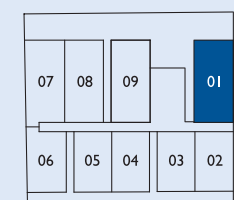

2ND STOREY PLAN

Note: Unit area includes AC ledge and/or AC accessory lot and/or void and/or roof terrace where applicable. All plans are subject to amendments as approved by the relevant authorities.

TYPE A2
1 bedroom
38 sq m / 409 sq ft
#02-02

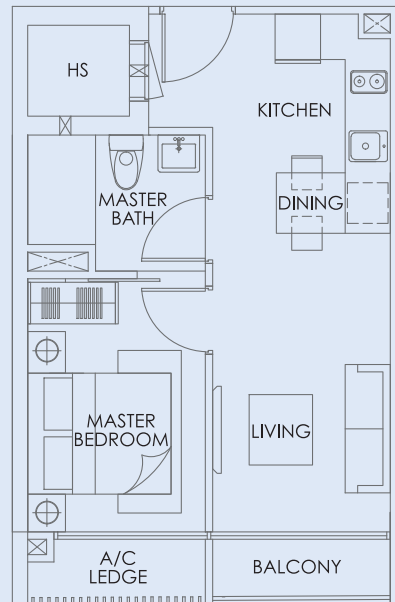

TYPE A2-I
1 bedroom
38 sq m / 409 sq ft
#03-02 to #05-02

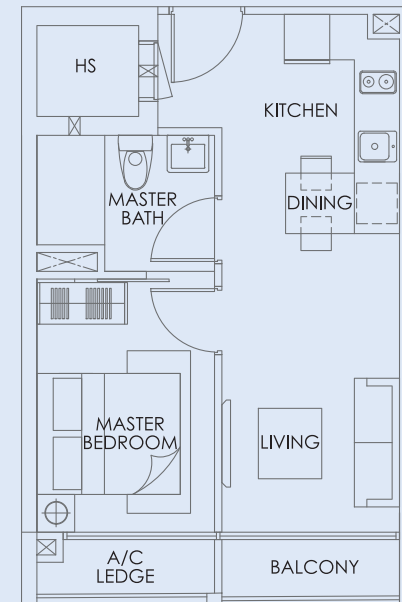

TYPE A3
1 bedroom
38 sq m / 409 sq ft
#02-03 to #04-03

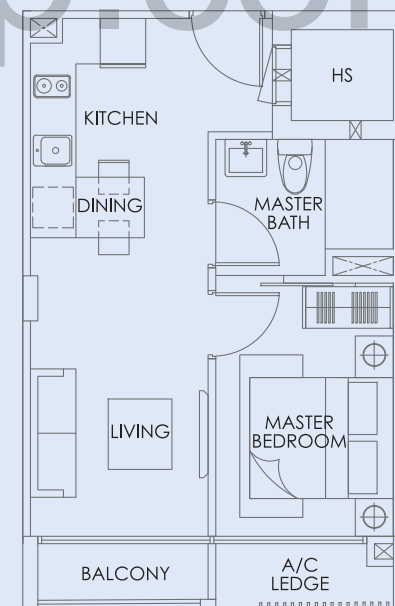

N
2ND STOREY PLAN
TO 5TH STOREY PLAN

Note: Unit area includes AC ledge and/or AC accessory lot and/or void and/or roof terrace where applicable. All plans are subject to amendments as approved by the relevant authorities.

www.huttonsgroup.com

TYPE A3-I
1 bedroom
38 sq m / 409 sq ft
#05-03

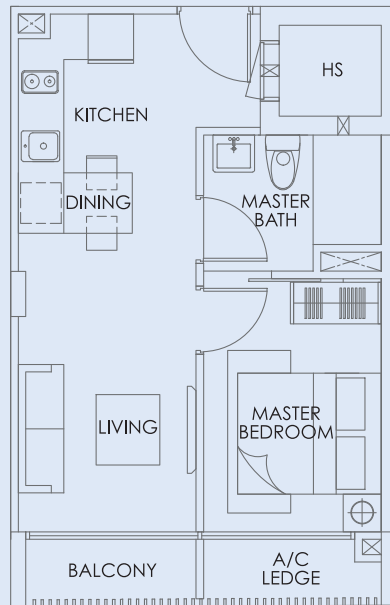

TYPE A3a
1 bedroom
38 sq m / 409 sq ft
#02-05 to #04-05

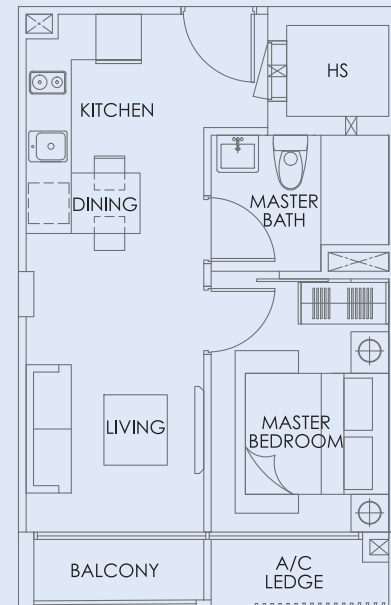

TYPE A3a-I
1 bedroom
38 sq m / 409 sq ft
#05-05

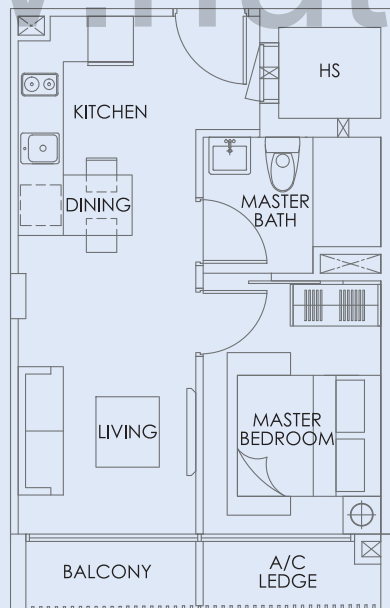

www.huttonsgroup.com

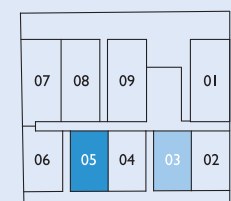

Note: Unit area includes AC ledge and/or AC accessory lot and/or void and/or roof terrace where applicable. All plans are subject to amendments as approved by the relevant authorities.

N 2ND STOREY PLAN
TO 5TH STOREY PLAN

TYPE A4
1 bedroom
38 sq m / 409 sq ft

#02-04

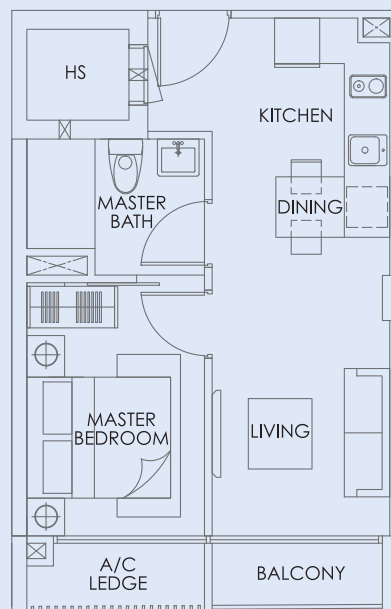

TYPE A4-I
1 bedroom
38 sq m / 409 sq ft

#03-04 to #05-04

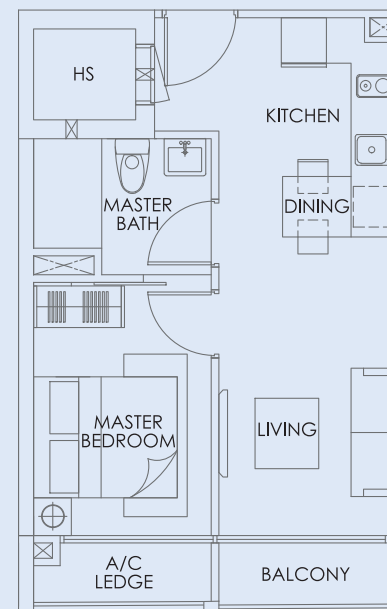

www.huttonsgroup.com

TYPE A5
1 bedroom
41 sq m / 441 sq ft

#02-06 to #05-06

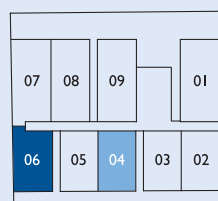
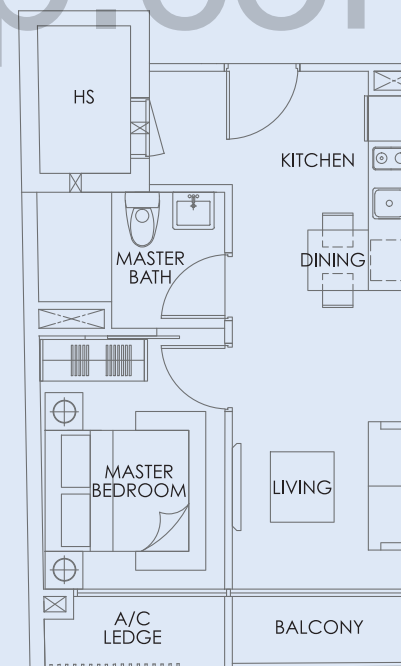

2ND STOREY PLAN
TO 6TH STOREY PLAN

Note: Unit area includes AC ledge and/or AC accessory lot and/or void and/or roof terrace where applicable. All plans are subject to amendments as approved by the relevant authorities.

TYPE A6

1 bedroom
42 sq m / 452 sq ft

#03-07 to #05-07

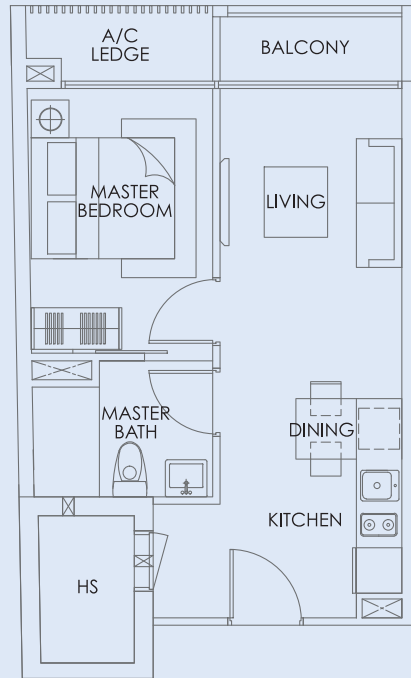

TYPE A6-2

1 bedroom
56 sq m / 603 sq ft

#02-07

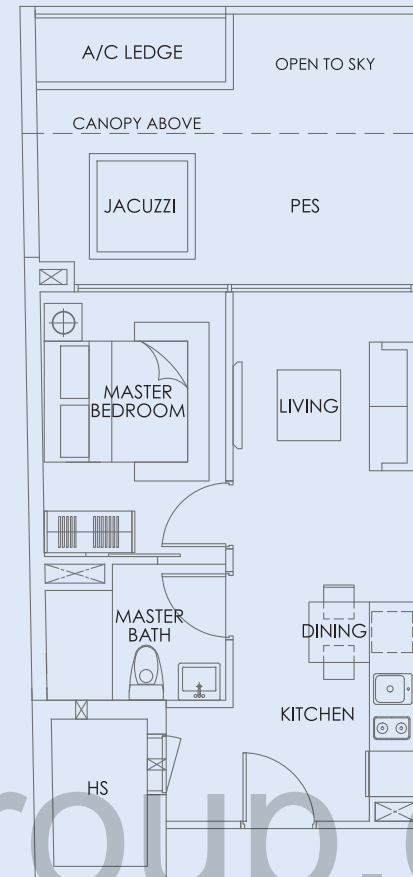

TYPE A6-1

1 bedroom
42 sq m / 452 sq ft

#06-07

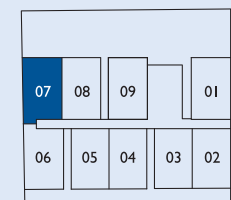
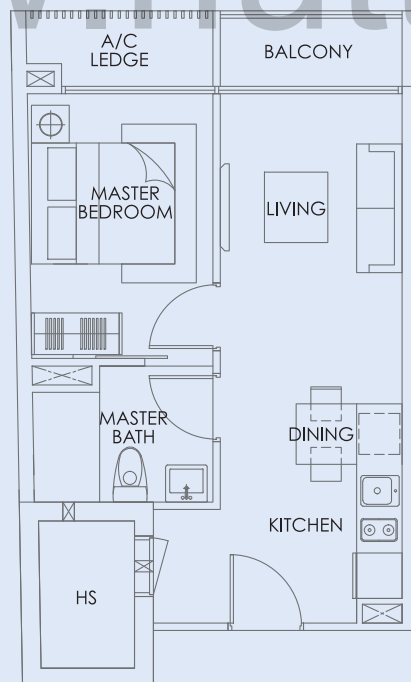

3RD STOREY PLAN
TO 6TH STOREY PLAN

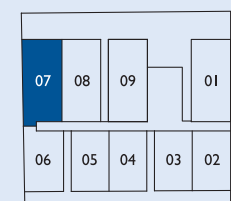

2ND STOREY PLAN

Note: Unit area includes AC ledge and/or AC accessory lot and/or void and/or roof terrace where applicable. All plans are subject to amendments as approved by the relevant authorities.

TYPE A7
1 bedroom
40 sq m / 431 sq ft
#03-08

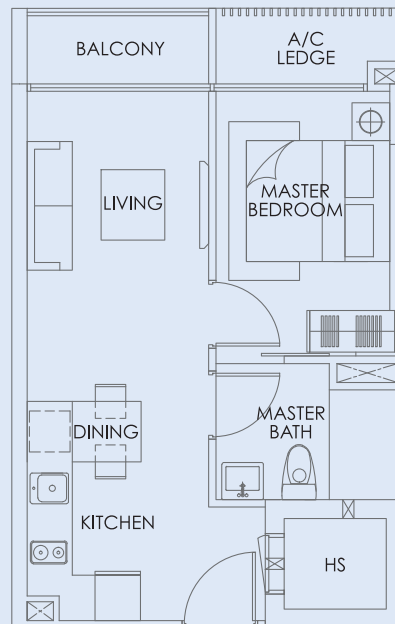

TYPE A7-1
1 bedroom
40 sq m / 431 sq ft
#04-08 to #06-08

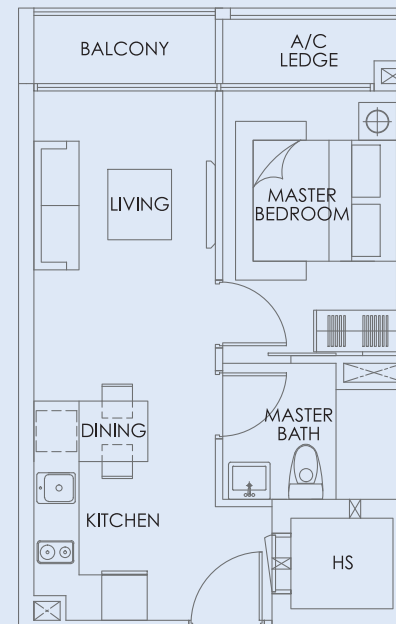

TYPE A7-2
1 bedroom
54 sq m / 581 sq ft
#02-08

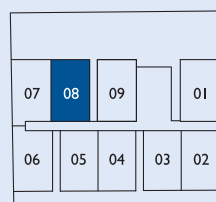
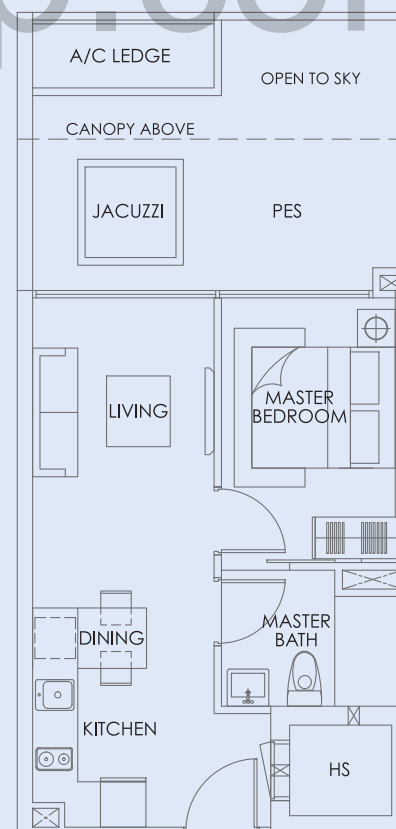

3RD STOREY PLAN
TO 6TH STOREY PLAN

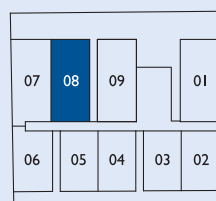

2ND STOREY PLAN

Note: Unit area includes AC ledge and/or AC accessory lot and/or void and/or roof terrace where applicable. All plans are subject to amendments as approved by the relevant authorities.

TYPE A8
1 bedroom
40 sq m / 431 sq ft

#03-09 to #05-09

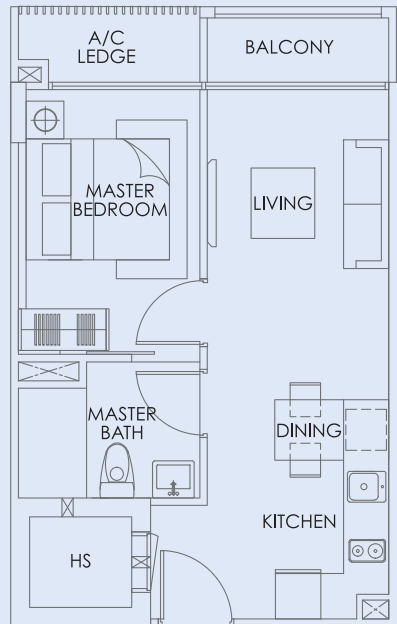

TYPE A8-2
1 bedroom
54 sq m / 581 sq ft

#02-09

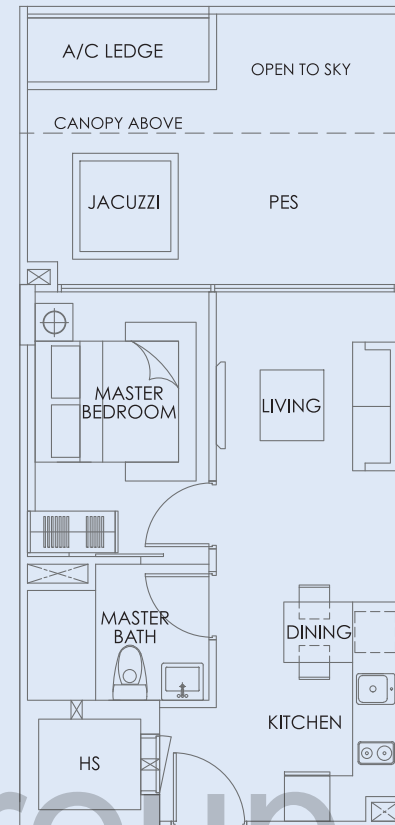

TYPE A8-1
1 bedroom
40 sq m / 431 sq ft

#06-09

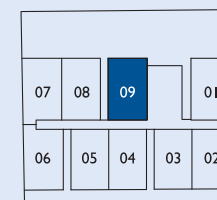
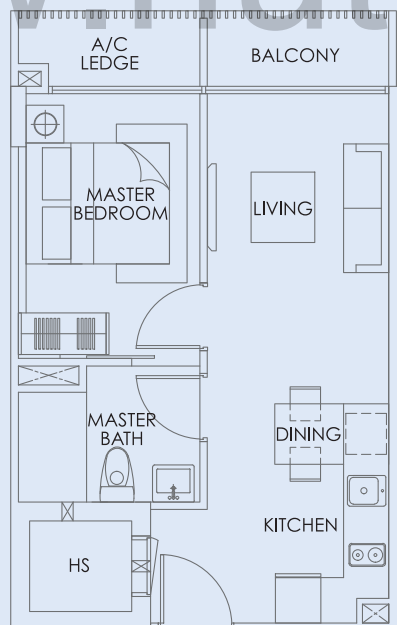

3RD STOREY PLAN
TO 6TH STOREY PLAN

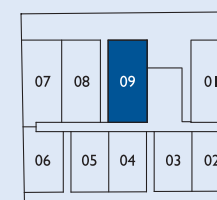

2ND STOREY PLAN

Note: Unit area includes AC ledge and/or AC accessory lot and/or void and/or roof terrace where applicable. All plans are subject to amendments as approved by the relevant authorities.

TYPE PH-1
1 bedroom
75 sq m / 807 sq ft

#06-01

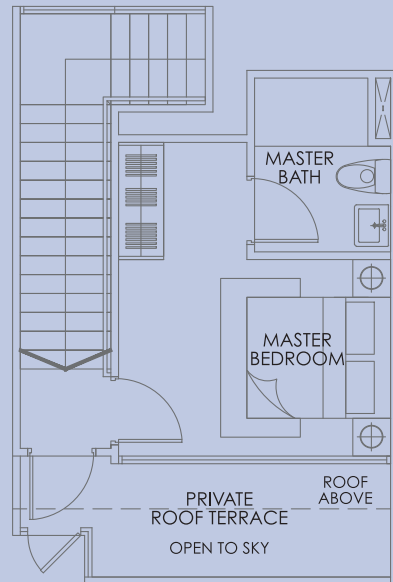

UPPER STOREY

TYPE PH-2
1 bedroom
75 sq m / 807 sq ft

#06-02

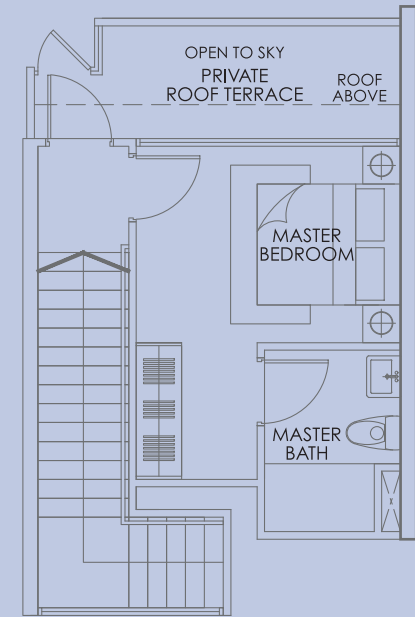

UPPER STOREY

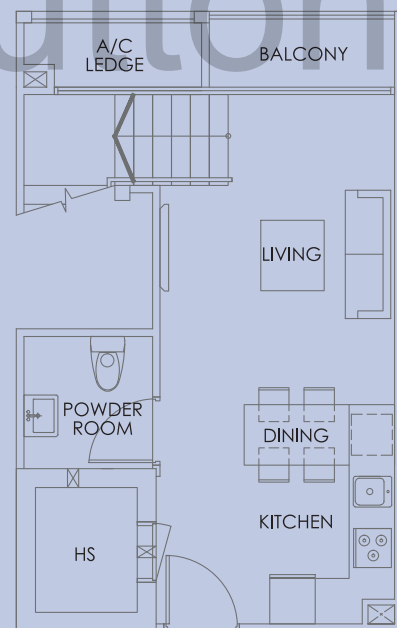

LOWER STOREY

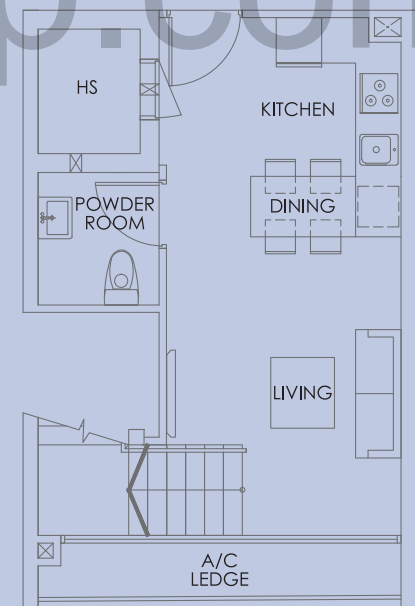

LOWER STOREY

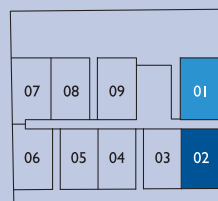

6TH STOREY PLAN

Note: Unit area includes AC ledge and/or AC accessory lot and/or void and/or roof terrace where applicable. All plans are subject to amendments as approved by the relevant authorities.

TYPE PH-3
1 bedroom
72 sq m / 775 sq ft

#06-03

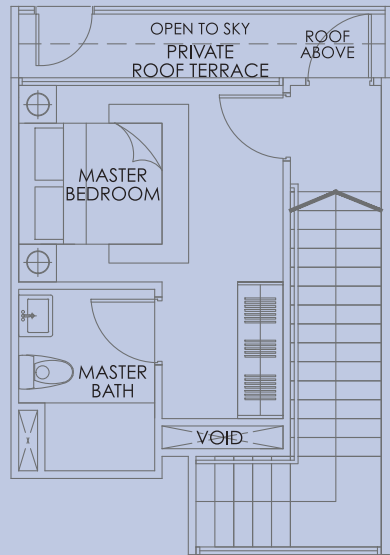

UPPER STOREY

TYPE PH-4
1 bedroom
79 sq m / 850 sq ft

#06-04

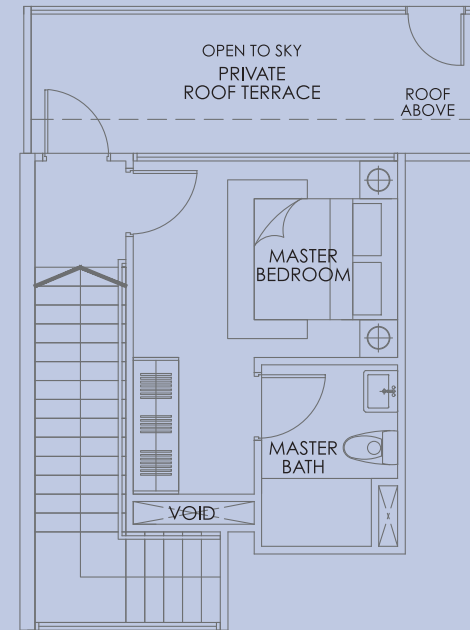

UPPER STOREY

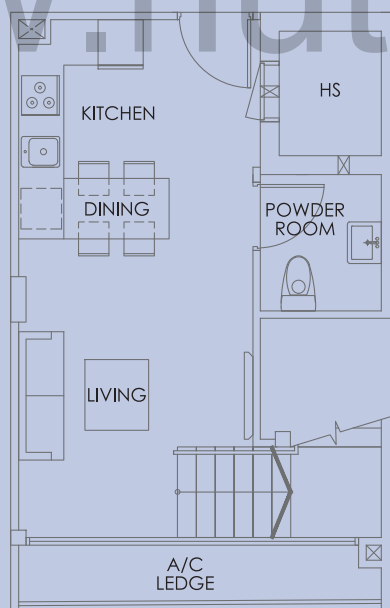

LOWER STOREY

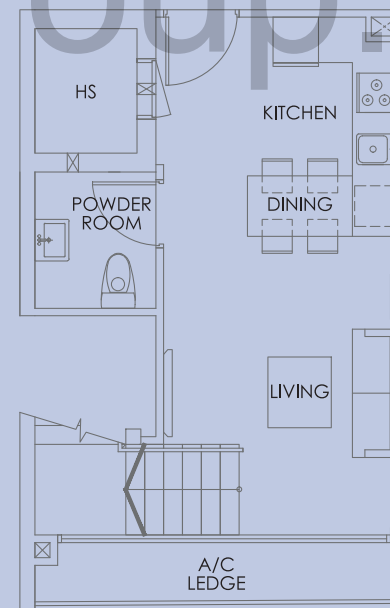

LOWER STOREY

07	08	09	01
06	05	04	03



6TH STOREY PLAN

Note: Unit area includes AC ledge and/or AC accessory lot and/or void and/or roof terrace where applicable. All plans are subject to amendments as approved by the relevant authorities.

www.huttonsgroup.com

TYPE PH-5
1 bedroom
77 sq m / 829 sq ft

#06-05

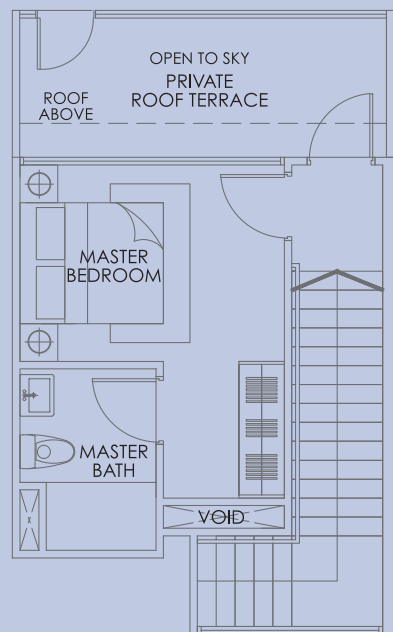

UPPER STOREY

TYPE PH-6
1 bedroom
82 sq m / 883 sq ft

#06-06

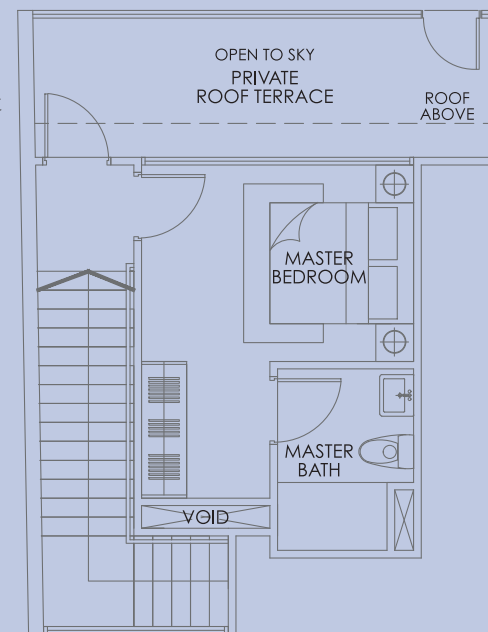

UPPER STOREY

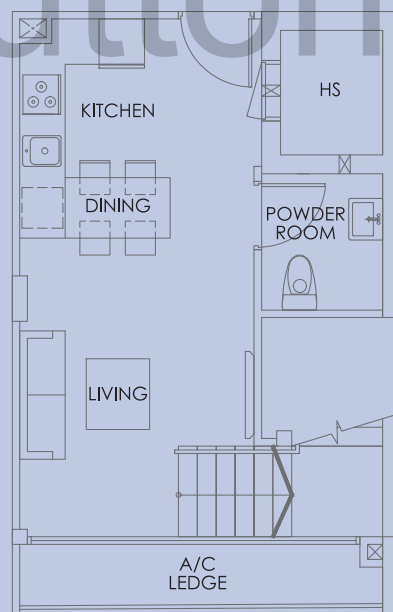

LOWER STOREY

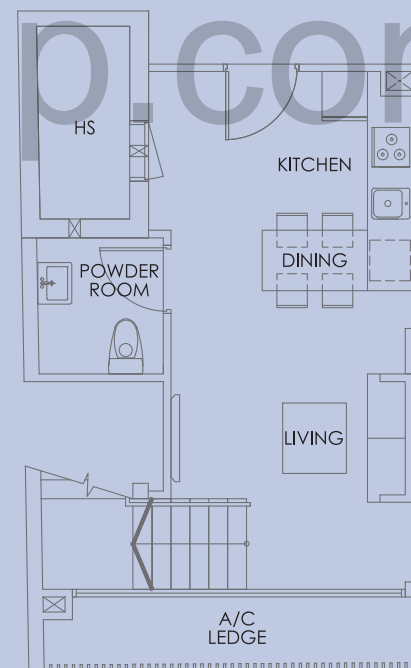

LOWER STOREY



6TH STOREY PLAN

Note: Unit area includes AC ledge and/or AC accessory lot and/or void and/or roof terrace where applicable. All plans are subject to amendments as approved by the relevant authorities.

www.huttonsgroup.com